

## EXTERIOR WALL S4.7

M1:10

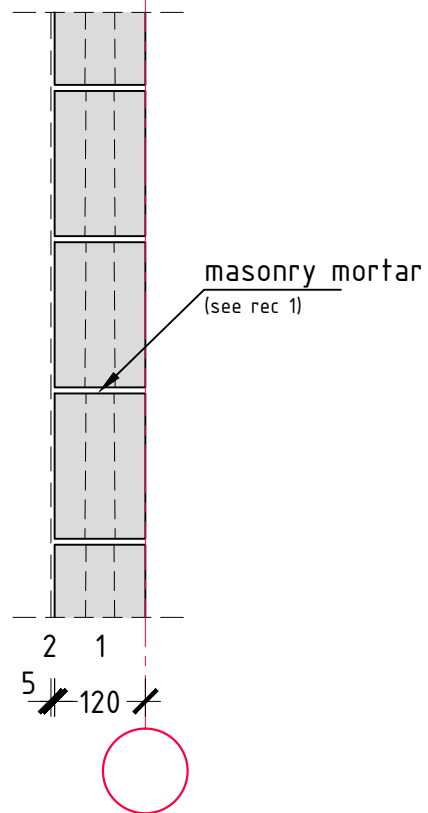

### CONSTRUCTION

#### Exterior wall

1. Silicate block 300x120x192mm
2. Exterior finish, fine-finish plaster

#### NOTE:

The drawing is of informative nature and not suitable for design work

STRUCTURE	NET WEIGHT [kN/m <sup>2</sup> ]	THERMAL CONDUCTIVITY [W/m <sup>2</sup> K]	RECOMMENDATIONS
EXTERIOR WALL	1,8	2,60	1. For more information on masonry mortar, see <a href="http://www.silikaat.ee/tooted/kuivsegud/">www.silikaat.ee/tooted/kuivsegud/</a>